

P127SMT1027O204G

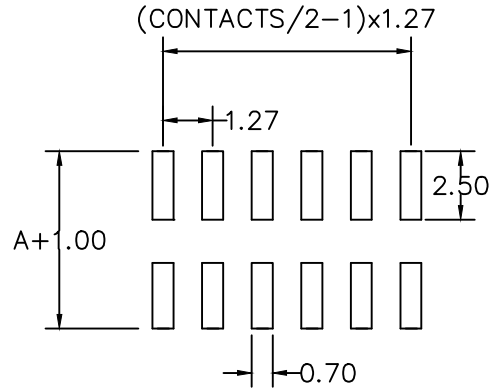

RECOMMENDED P.C.B LAYOUT

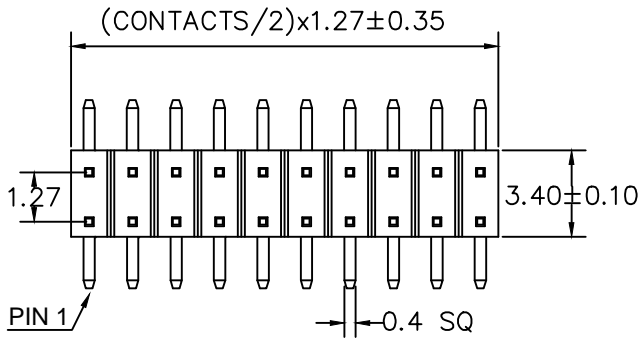
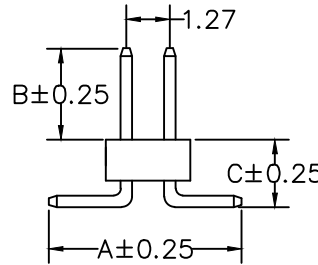
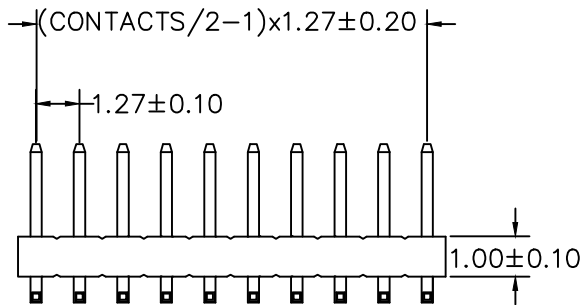

A: 10.27 mm B: 4.10 mm C: 1.50 mm

MATERIAL

HOUSING : NYLON 6T,UL94V-0
 CONTACT : COPPER ALLOYS
 PLATED : GOLD-FLASH
 COLOR : BLACK

SPECIFICATION

CURRENT: 1A
 OPERATING TEMPERATURE: -55°C TO +105°C
 CONTACT RESISTANCE : 20 MILLIOHMS MAX
 INSULATION RESISTANCE : 5000 MEGAOHMS MIN
 DIELECTRIC STRENGTH : 1000 VA

CONTACTS	2X26
2X2	2X27
2X3	2X28
2X4	2X29
2X5	2X30
2X6	2X31
2X7	2X32
2X8	2X33
2X9	2X34
2X10	2X35
2X11	2X36
2X12	2X37
2X13	2X38
2X14	2X39
2X15	2X40
2X16	2X41
2X17	2X42
2X18	2X43
2X19	2X44
2X20	2X45
2X21	2X46
2X22	2X47
2X23	2X48
2X24	2X49
2X25	2X50

比例 (SCALE)	FREE	繪圖 (DRAW)	Tina	FLYiNG INTERNATIONAL
單位 (UNIT)	MM	審核 (CHECK)	/ /	
一般公差 (TOLERANCE)		承認 (AP*E)	/ /	圖名 (NAME) : PIN HEADER 1.27X1.27 SMT
.0±0.38 .00±0.25 ANG=±5°		投影法 PROJECTION	第三角	料號 (PART NO) 114-23XX4-XXXX
				圖號 (DRAW NO) 2XSMT