

(3-20PIN)

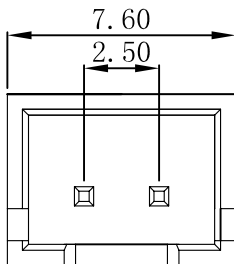

(2PIN)

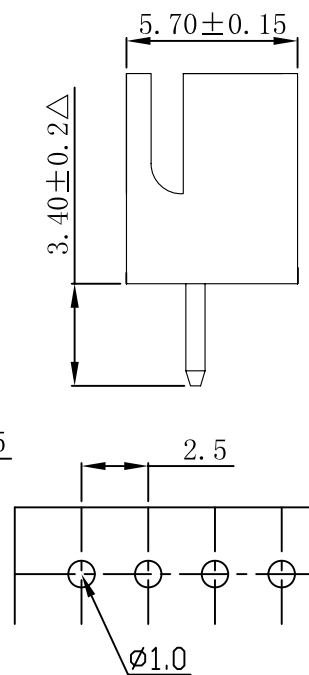
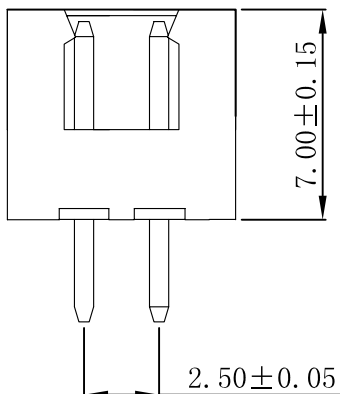
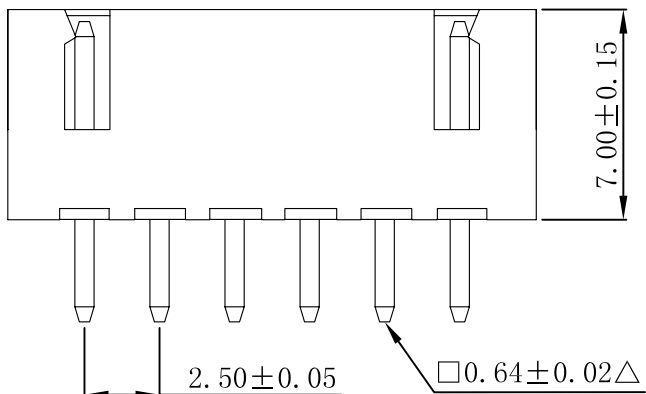

P. C. B Hole Layout

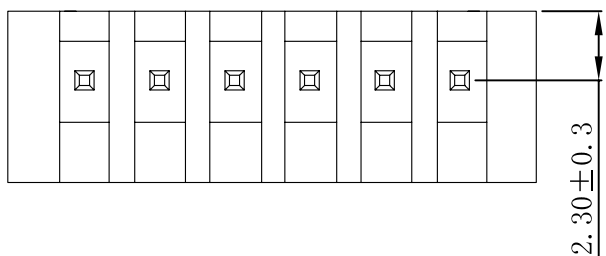

## Specifications

Current Rating	:3A AC, DC
Voltage rating	:250V AC, DC
Temperature range	: -25°C ~ +85°C
Contact resistance	:10mΩ Max
Insulation resistance	:1000MΩ Min
Withstanding voltage	:1000 V AC/minute
Finished	:Tin-plated
Housing Material	:Nylon-66, UL94 V-0
Color	:Ivory-white

Circuits	Part NO.	Dimension mm	
		A	B
2	CX-W250-02	2.50	7.60
3	CX-W250-03	5.00	10.10
4	CX-W250-04	7.50	12.60
5	CX-W250-05	10.00	15.10
6	CX-W250-06	12.50	17.60
7	CX-W250-07	15.00	20.10
8	CX-W250-08	17.50	22.60
9	CX-W250-09	20.00	25.10
10	CX-W250-10	22.50	27.60
11	CX-W250-11	25.00	30.10
12	CX-W250-12	27.50	32.60
13	CX-W250-13	30.00	35.10
14	CX-W250-14	32.50	37.60
15	CX-W250-15	35.00	40.10
16	CX-W250-16	37.50	42.60
17	CX-W250-17	40.00	45.10
18	CX-W250-18	42.50	47.60
19	CX-W250-19	45.00	50.10
20	CX-W250-20	47.50	52.60

**FLYING**  
INTERNATIONAL

DESCRIPTION(內容):  
XH 2.5mm Wafer 180° 不打K □=0.64  
(環保材料)

PART NO:  
(料號) CX-W250-XX

DWG NO(圖號):

DRAWN(製圖):  
王建平

CHECKED(確認):

APPROVAL(核准):

GENERAL TOLERANCE:  
(公差)

.0 ±0.20  
.00 ±0.15  
.000 ±0.10

SCALE(比例):  
1:XX

REV:  
A/6

UNIT:  
mm

SIZE:  
A4

SHEET:  
1/1

REV

1

2

3

4

DESCRIPTION

△此符號表示重點管控尺寸

(1D)增加產品顏色標注

增加PIN中心点到塑膠邊緣的尺寸

增加2PIN示意图

DATE

2005.08.13

2007.07.08

2009.12.10

2012.04.10