

UNSHIELDED SMD POWER INDUCTORS / CDS TYPE

FEATURES

- ◆ Designed for the smallest possible size and high performance
- ◆ They are with high energy storage and very low resistance making them the ideal inductors for DC-DC conversion in the following applications
- ◆ CDS1704, and CDS2506 used ceramic base with gold-plating



APPLICATIONS

- ◆ Notebook
- ◆ Digital camera & scanner
- ◆ CD-Rom & DVD DC/DC converter

ORDERING CODE

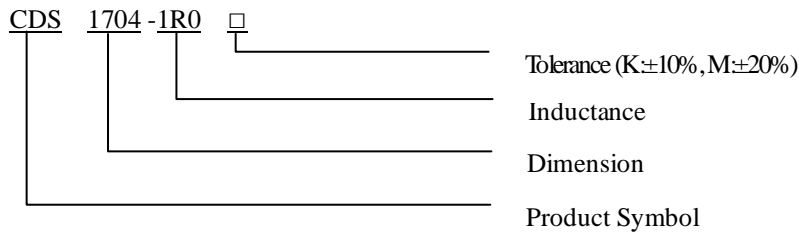

SHAPES

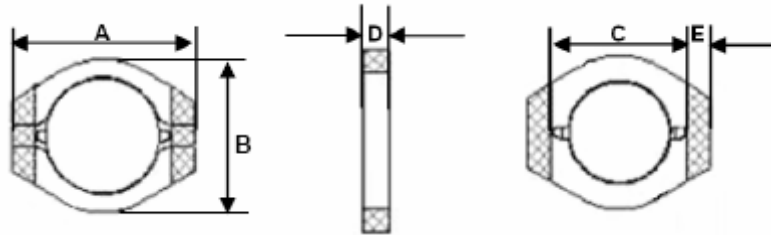

DIMENSIONS (UNIT: mm)

Part No.	A(Max)	B(Max)	C(Max)	D(Max)	E(Ref.)
CDS 1704	6.60	5.50	4.90	1.15	0.75
CDS 2506	9.14	7.87	7.40	1.65	0.87

UNSHIELDED SMD POWER INDUCTORS / CDS TYPE

ELECTRICAL CHARACTERISTICS FOR CDS1704

Part No.	Inductance (uH)	RDC (Ω)	IDC (A)
CDS1704-1R2 □	1.2	0.080	2.10
CDS1704-1R5 □	1.5	0.100	1.90
CDS1704-2R2 □	2.2	0.120	1.60
CDS1704-3R3 □	3.3	0.160	1.30
CDS1704-4R7 □	4.7	0.200	1.10
CDS1704-6R8 □	6.8	0.320	0.90
CDS1704-100 □	10	0.368	0.90
CDS1704-150 □	15	0.550	0.65
CDS1704-220 □	22	0.850	0.50
CDS1704-330 □	33	1.300	0.40
CDS1704-470 □	47	1.800	0.35
CDS1704-680 □	68	2.500	0.30
CDS1704-101 □	100	3.500	0.25
CDS1704-151 □	150	5.000	0.18
CDS1704-221 □	220	7.000	0.16
CDS1704-331 □	330	15.000	0.13

UNSHIELDED SMD POWER INDUCTORS / CDS TYPE

ELECTRICAL CHARACTERISTICS FOR CDS2506

Part No.	Inductance (uH)	RDC (Ω)	IDC (A)
CDS2506-4R7 □	4.7	0.145	1.60
CDS2506-6R8 □	6.8	0.150	1.45
CDS2506-100 □	10	0.240	1.00
CDS2506-150 □	15	0.300	0.90
CDS2506-220 □	22	0.400	0.80
CDS2506-330 □	33	0.550	0.60
CDS2506-470 □	47	0.765	0.50
CDS2506-680 □	68	1.100	0.40
CDS2506-101 □	100	1.600	0.30
CDS2506-151 □	150	2.500	0.25
CDS2506-221 □	220	3.650	0.22
CDS2506-331 □	330	4.650	0.18
CDS2506-471 □	470	6.750	0.14
CDS2506-681 □	680	9.150	0.12
CDS2506-102 □	1000	14.20	0.10

* Test Frequency : 100KHZ/0.1V