

No	NAME	MATERIAL	NATIONALITY	QTY	FINISHING
1	Terminal	Brass	China	1	Silver plating
2	Case	PA66	China	1	Black
3	Contact	Phosphor bronze	Korea	1	Contact side silver plating
4	Cover	SPCC-SD	China	1	CuSn plating
5	Stem	PA66	China	1	Black L≤17mm
		PC	China	1	Black L>17mm

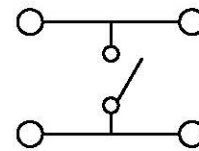

CIRCUIT

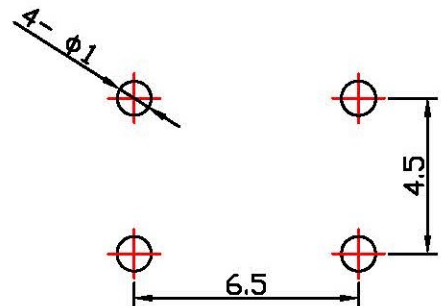

P C B Layout

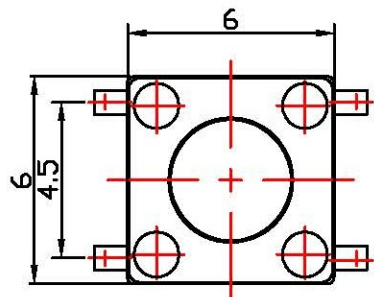

### FLY-1102(L)-(OF)-(B)-K

TYPE	1	2	3
Operating Force	100±30gf	160±30gf	250±50gf
Return force	20gf	40gf	60gf

STEM Color:	
B:	Black
R:	Red

- Rating: DC12V 50mA
- Contact Resistance : 50mΩ max(initial)
- Insulation Resistance: 100MΩ
- Electrically Life: 100gf 100,000 cycles  
160gf 80,000 cycles  
250gf 60,000 cycles
- Travel: 0.25±0.1mm
- General tolerance: ±0.20mm

Model.No.	AC	AE	A	AL	AA	AB	AD	B	E	N	NL	C	Y	R	D	X	U	L	M	K	F	I	G	W	O	Q	QR	QS	J	H	HX	HZ	Z	ZL	ZB	ZC	ZA	ZZ	ZR	
L(mm)	4.3	4.5	4.8	5	5.5	6.0	6.5	6.8	7.0	7.3	7.5	7.7	8.0	8.5	9.0	9.5	10	10.5	11	11.5	12	12.5	13	13.5	14	14.5	15	15.3	15.5	16	17	18	19	20	21	22	23	25	26	29

	單位	比例	日期	核准	審核	設計繪圖	料號	FLY-1102(L)-(OF)-(B)-K										頁數	1/1
	mm	FREE	2017-01-05	WILLIAM	AMY	EWS	品名	TACT SWITCH										版本	B
							圖號												